

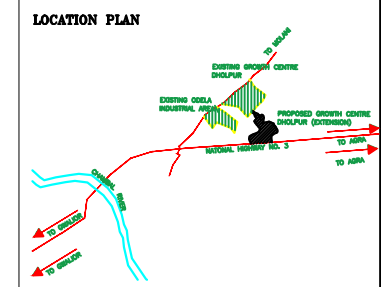

GROWTH CENTRE, DHOLPUR (EXTENSION)



SCHEDULE OF PLOTS

TYPE	SIZE IN METERS	AREA IN SQ. MET.	NO.	SET BACKS				
				FRONT	SIDE	REAR	SEMI	
B	30.00x30.00	900	17	8	4	4	4	
F	30.00x30.00	900	78	8	8	8	8	
G	30.00x30.00	900	81	8	8	8	8	
G1	30.00x30.00	900	81	8	8	8	2.5	
E	30.00x30.00	900	4	8	8	8	8	
E1	30.00x30.00	900	14	8	8	8	1.5	
F	30.00x30.00	900	18	8	1.5	8	1.5	
TOTAL NO. OF PLOTS				909				

LAND USE:-

DESCRIPTION	AREA IN ACRES	PERCENTAGE
TOTAL AREA UNDER SCHEME	218.38	
AREA UNDER INDUSTRIAL PLOTS	127.80	58.5%
AREA UNDER ROADS	94.17	43.1%
AREA UNDER COMMERCIAL	11.88	5.4%
AREA UNDER SERVICES	3.82	1.8%
AREA UNDER OPEN	4.33	2.0%
AREA UNDER RESERVED	3.80	1.7%

- NOTES:-**
- THIS DRAWING HAS BEEN APPROVED BY M.D. VIDE PARA 24/A ON DATED 10/09/2002 FOR THE LETTER ON DATED 28/09/2002 IN SECTION FILE.
 - STRUCTURES COMING INSIDE THE SCHEME AREA MAY BE DEMOLISHED.
 - FOR LAND TO THE EXISTING GROWTH CENTRE AREA, CERTAIN CHANGES HAVE BEEN DONE IN THE BLOCK CONTAINS PLOT NO. 8-187 TO 8-180 OF THE EXISTING GROWTH CENTRE.
 - PLAN RELEASED FOR DEMARCATION PURPOSE, THE FINAL PLAN SHALL BE RELEASED AFTER DEMARCATION PLAN IS RECEIVED AND APPROVED BY COMPETENT AUTHORITY.

PROPOSED TENTATIVE LAYOUT PLAN FOR GROWTH CENTRE DHOLPUR (EXTENSION)

SCALE:- 1 CM= 30.00 MET. **NO. 1199/2002 DATED 28/09/2002.**

M.D./
 TOWN ENGINEER
 DHOLPUR

M.D./
 SURVEY & PLANNING
 DHOLPUR

M.D./
 PUBLIC WORKS
 DHOLPUR



RIICO

TOTAL PLOT AREA OF COMMERCIAL PLOT 210.40 SQM
 PROPOSED SHOPS (100X30 MT) 27 NOS.
 NOTE: THIS DRAWING HAS BEEN PREPARED AS PER THE SURVEY RECEIVED FROM UNIT OFFICE.
 2. FOR DETAIL OF SHOPS REFER D.M.G. NO. 19/466/94 DT. 20.04.06

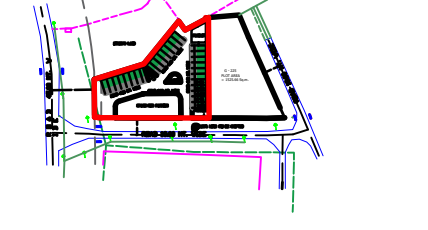

SCHEDULE OF PROPOSED PLOTS/ SHOPS

1. COMMERCIAL PLOT- 11 INDS.
 2. SHOPS-S TYPE 07NDS.3.00M X 7.50M

